

USER MANUAL

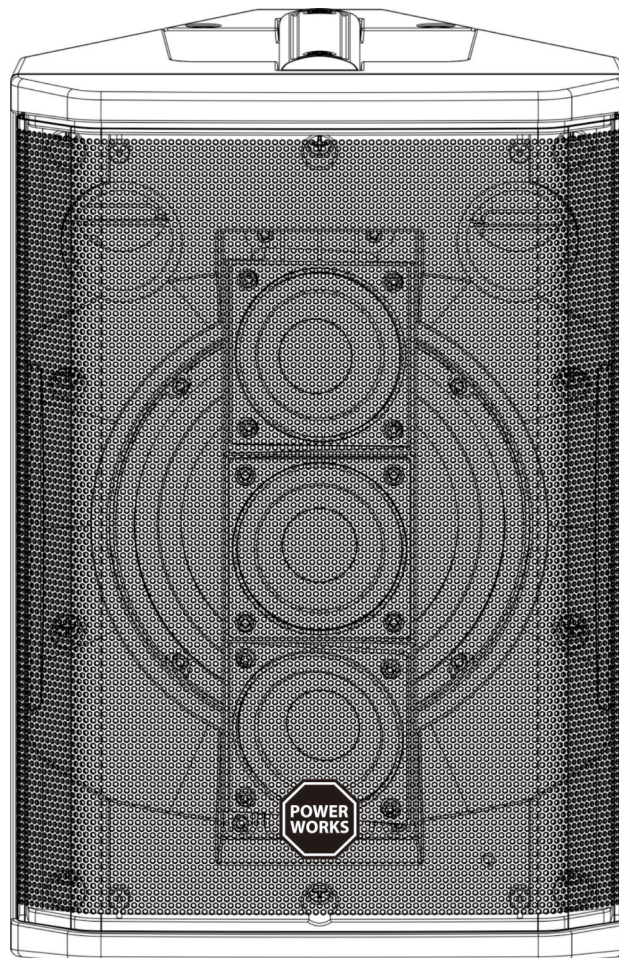

PA-6
PA-8



SAFETY INTRODUCTION

1. Please read the manual carefully and keep it for future reference.
2. All safety instructions and warnings must be adhered to. They are part of the manual and must be kept with the manual.
3. Any guarantee claims are rendered invalid if damage occurs due to non-observance of these operating instructions. We assume no liability for any consequent damage.
4. We assume no liability for personal injury or damage to property caused by incorrect handling or non-observance of the safety instructions. Any guarantee claims expire in such cases.
5. Unauthorized conversions and/or modifications of the appliance are not permitted for safety and licensing reasons (CE).
6. The appliance is approved for operation in dry, closed rooms only. Do not operate the device nearby water, such as in bathrooms or nearby swimming pools.
7. The appliance may not be exposed to extreme temperatures ($< +5^{\circ}\text{C}$ / $> +35^{\circ}\text{C}$) in operation.
8. The appliance may not be subjected to strong vibrations or heavy mechanical strain.
9. The appliance may not be exposed to excessive moisture (due to dripping or sprayed water, for example).
10. Do not place any recipients filled with liquids, such as glasses or vases, on top of or directly next to the appliance. They could fall over, causing water to enter the appliance. Never pour out liquids above the appliance. Do not place any small objects, such as coins or paper clips, on the appliance since they could fall inside the appliance. You run a high risk of causing a fire or life-threatening electrocution! If any liquid or objects enter the appliance nevertheless, pull the mains plug out of the socket immediately and contact a specialist.
11. The appliance has been constructed according to protection class I. The power plug must only be plugged into a protection class I outlet. The voltage and frequency must exactly be the same as stated on the device. Wrong voltages or power outlets can lead to the destruction of the device and to lethal electrical shock.
12. 110- 240 Vac, 50/60 Hz mains socket may be used as source of power for the appliance. Never try to operate the appliance with any other voltage.
13. Only pull the mains plug out of the socket by the intended gripping surface. Do not pull it by the cable.
14. Never plug the mains plug in or out with damp or wet hands.
15. Always pull the mains plug out of the mains socket:
16. Before cleaning the appliance
17. If there is a thunderstorm
18. If you will not be using the appliance for a long period of time (> 1 week)

19. Electrical appliances must be kept out of the reach of children. Be particularly careful if children are present. Children are not aware of the hazards involved in handling electrical appliances improperly. Children could attempt to poke objects into the appliance. There is a life-threatening danger of electrocution.

20. Do not leave the appliance unattended while operating it.

21. Never place the appliance on an unstable or movable surface. Persons could be injured or the appliance damaged by it falling down.

22. When using a rack, make sure it is in a stable position and is transported securely. Installation on uneven, slanted surfaces or stopping the rack abruptly during transport can result in the rack overturning or appliances falling from or out of the rack and injuring people.

23. Live components can be exposed by opening covers or removing components (unless this can be done without tools). Contact points can also be live. If the appliance has to be opened in order to calibrate, service, repair or replace components or assemblies, all of its poles must be disconnected from all sources of voltage first. If the appliance has to be kept open and under voltage during maintenance or repairs, this work may only be carried out by a specialist who is familiar with the risks involved and the relevant regulations.

24. Never connect the appliance directly after transferring it from a cold to a warm room. The condensation water that forms could destroy the appliance or result in an electric shock. Allow the device to reach room temperature before connecting it. Wait until the condensation water has evaporated. This can take some hours.

25. Do not place any naked flames such as those of burning candles on or next to the appliance.

26. Do not place the appliance on soft surfaces such as carpets or beds. Do not cover the air vents of the appliance. Do not obstruct the air circulation with objects such as magazines, table cloths or curtains. This prevents the dissipation of heat from the appliance and can result in overheating.

27. Only use the appliance in a moderate climate, not in tropical environments.

28. All persons involved in operating, installing and servicing the appliance and putting it into service must be trained and qualified accordingly and observe these operating instructions.

29. Defective mains cables may only be replaced by specialists. Danger of shock hazard!

30. Do not leave the packaging material lying around carelessly since it can become a source of danger for children playing with it.

31. The accident prevention regulations and the regulations of the employers' liability insurance association should be observed at commercial institutions.

32. If you are not sure about the correct connection or if questions arise which are not answered by the operating instructions, please do not hesitate to contact support or a specialist of your choice. Consult a specialist if you are in doubt about the operating principle or the safety of the product.

PA-6

PA-8

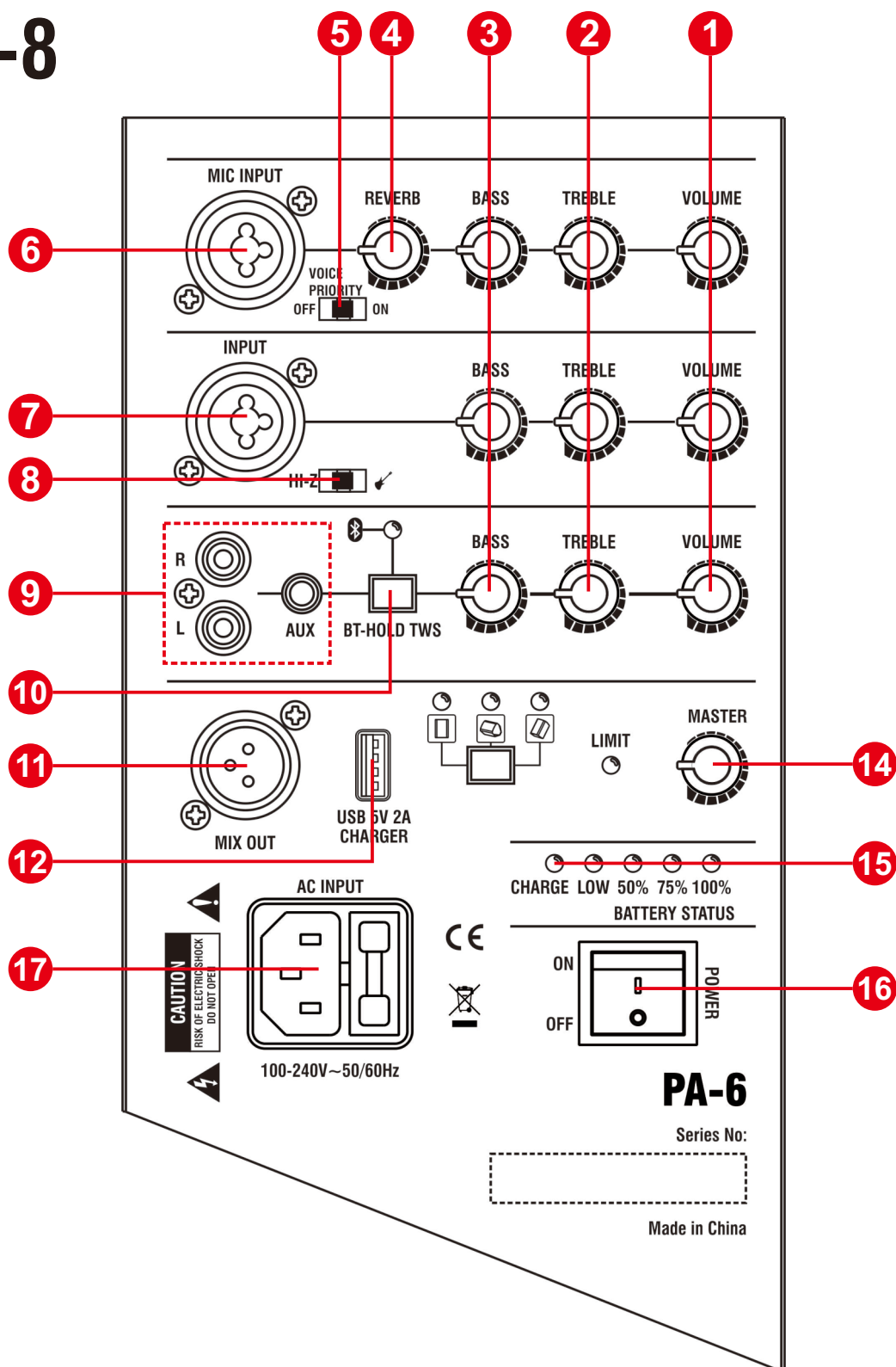

1.VOLUME CONTROL

Adjust the volume of your microphone, instrument or audio source.

2.TREBLE CONTROL

Adjust the high-frequency balance of your microphone or instrument.

3.BASS CONTROL

Adjust the low-frequency balance of your microphone or instrument.

4.REVERB CONTROL

Adjust the amount of reverb applied to your microphone or instrument.

5.VOICE PRIORITY SWITCH

Move the switch to the NO or OFF position to enable the Voice Priority preset.

6.MIC INPUT

Analog input for connecting microphone (XLR) and instrument (TS unbalanced) cables.

7.SIGNAL INPUT

Analog input for connecting XLR and instrument (TS unbalanced) cables.

8.SWITCH

Move the switch to the LINE or Guitar position to enable the Voice Priority preset.

9.SIGNAL INPUT

Analog input for connecting RCA and AUX cables.

10.BLUETOOTH PAIR BUTTON

Used to set up pairing with Bluetooth-capable devices, such as mobile phones, tablets, and laptops.

11.MIX OUT

This is a male XLR-type connector that produces a processed mix of both Mic/Line Inputs. Use it to daisy-chain several active speakers together.

12.USB 5V 2A CHARGER

13.Connection Scenarios SWITCH

14.MASTER SWITCH

This controls the overall level of the speaker.

15.BATTERY STATUS

When you connect the power cable, you can check battery charge (even without switching the unit on) basing on how many of the four LEDs are on. When charge level is below 25%, the red LED flashes and indicates that you need to re-charge the battery as soon as possible.

16.POWER SWITCH

Switch up to turn the speaker on, and switch down to turn it off. Make sure the level control is down before you turn it on.

7.IEC Socket with Fuse holder

Plug the line cord into an AC socket properly configured for your particular model. In case of fuse burn, to prevent the risk of fire and damaging the unit, Before replacing the fuse, make sure the unit turned off and disconnected from the AC outlet.

1. SCENARIOS SWITCH

Elevated Surface

Position the speaker on a surface. This projects sound clearly and evenly throughout the audience, and ensures that audience members enjoy the full frequency range of the system.

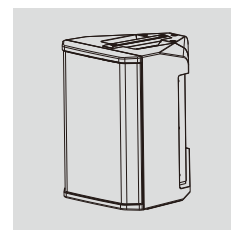

Tilt-Back

For performances where your audience is close to you, tilt the speaker onto its back edge. For best results, the performer should stand or sit to one side of the loudspeaker to avoid blocking sound from the audience.

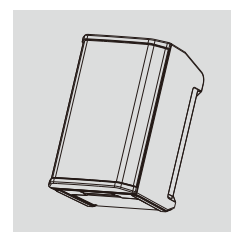

Monitor

To use the speaker as a personal floor monitor, place it on the ground horizontally, in front of and pointing toward the performer. Tilt the loudspeaker onto its side edge.

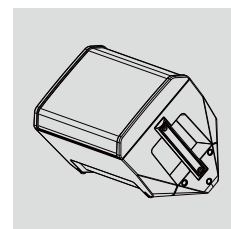

2. "Bluetooth" Examples of Input connections

LED Flash while power on. Search for "Bluetooth" to connect with your devices, Turn on another speaker will be connected automatically. The speaker connect with your device will be right Channel.

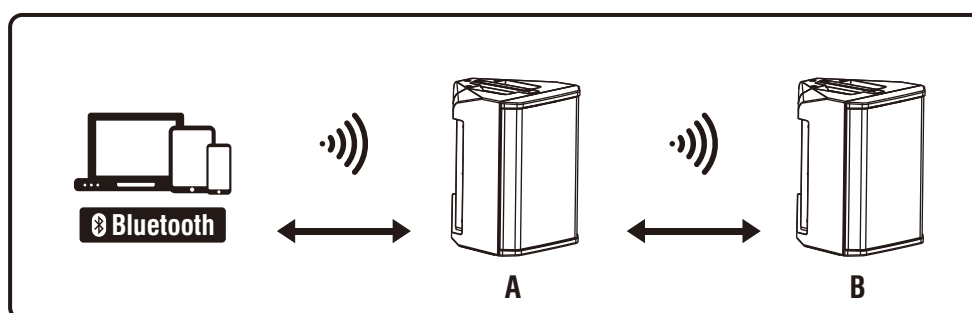

3.Examples of Input connections

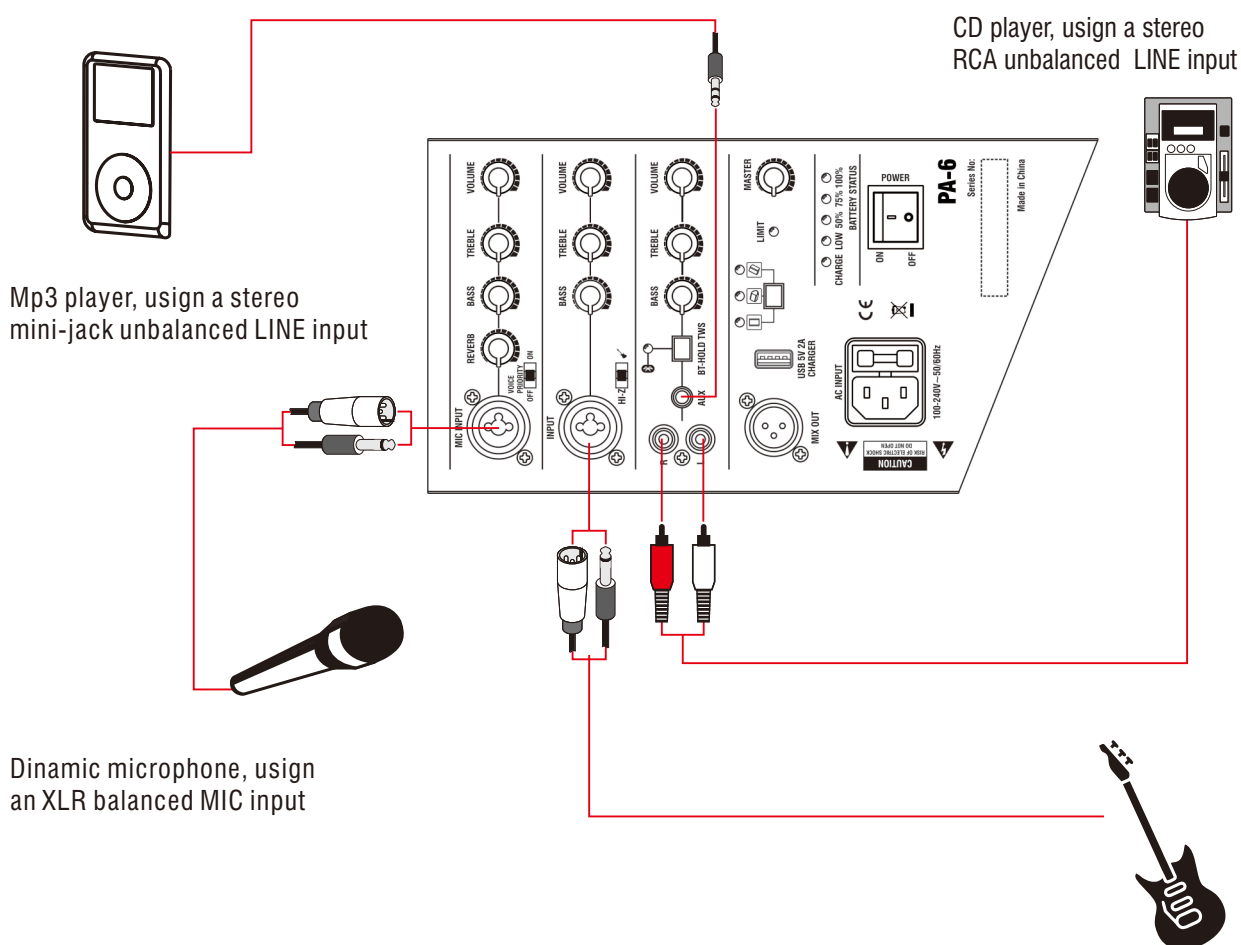

4.Stereo operation with a mixer

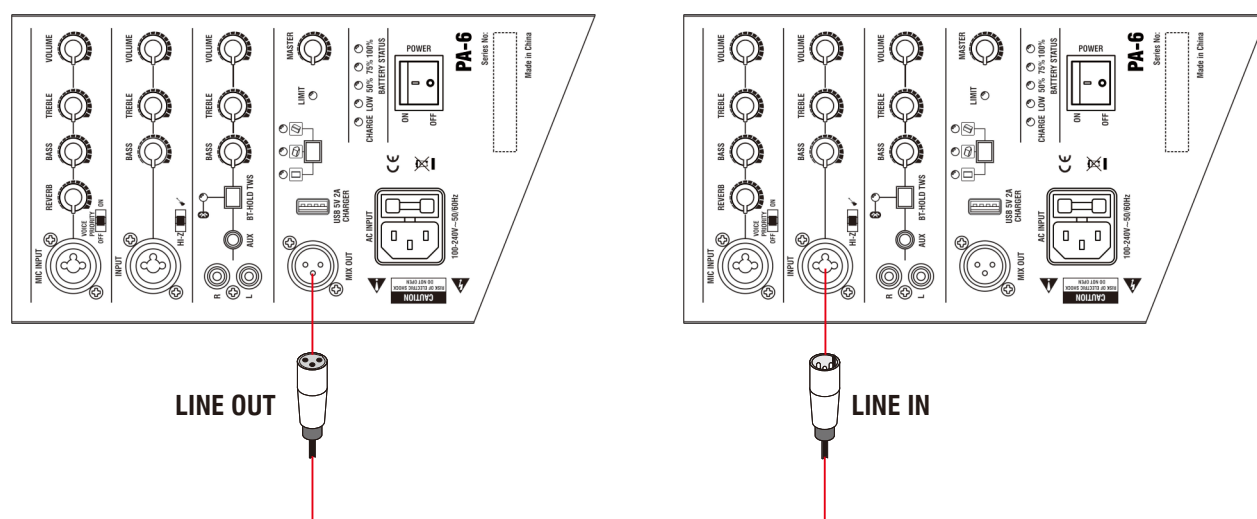

TECHNICAL SPECIFICATIONS

Model:	PA-6
Product type:	Portable PA Speaker
Type:	Active
Low/mid driver dimensions :	6.5"
Woofer magnet:	Ferrite
Vertical array system:	3 x 2.75" Wideband Speakers
Amplifier:	2 x Class D
RMS:	100W+100W
Peak power:	200W+200W
Frequency response:	65Hz-20kHz
SPL(1W/1m):	93dB
Max.SPL:	110dB
Protection circuits:	Short circuit overcurrent
Controls:	Master, Voice priority on/off, Line Gain, Bass Treble, Power, Mic Gain
Indicators:	Charge/battery status,Power
Supported media(opinion):	2 x XLR/6.3mm Jack combo / RCA / 3.5mm/ Bluetooth
Line inputs:	3
Line input connectors:	RCA, 6.5mm/XLR, 3.5mm Jack
Mic inputs:	XLR/ 6.3mm Jack
Mix outputs:	1
Line output connectors:	XLR
Operating Voltage:	AC 100-240V 50/60Hz
Battery capacity:	7 hours 100% power /12 hours 50% power // 28.8V /5,200mAh
Other features:	35mm stand mount, transport handle
Indicators:	Charge/battery status, Power
Dimensions:	380 x 500 x 335mm
Weight:	8.2kg

TECHNICAL SPECIFICATIONS

Model:	PA-8
Product type:	Portable PA Speaker
Type:	Active
Low/mid driver dimensions :	8"
Woofer magnet:	Ferrite
Vertical array system:	3 x 2.75" Wideband Speakers
Amplifier:	2 x Class D
RMS:	120W + 120W
Peak power:	240W + 240W
Frequency response:	50Hz-20kHz
SPL(1W/1m):	95dB
Max.SPL:	120dB
Protection circuits:	Short circuit overcurrent
Controls:	Master, Voice priority on/off, Line Gain, Bass Treble, Power, Mic Gain
Indicators:	Charge/battery status,Power
Supported media(opinion):	2 x XLR/6.3mm Jack combo / RCA / 3.5mm/ Bluetooth
Line inputs:	3
Line input connectors:	RCA, 6.5mm/XLR, 3.5mm Jack
Mic inputs:	XLR/ 6.3mm Jack
Mix outputs:	1
Line output connectors:	XLR
Operating Voltage:	AC 100-240V 50/60Hz
Battery capacity:	7 hours 100% power /12 hours 50% power // 28.8V /5,200mAh
Other features:	35mm stand mount, transport handle
Indicators:	Charge/battery status, Power
Dimensions:	425 x 535 x 377mm
Weight:	9.4kg

